

If we could design London we would...

We would take the airspace above and bring together the Local Authorities and the pioneering Housing Associations to **create ...** ask the councils and public sector bodies what they are doing with their car parks today?

PROBLEM

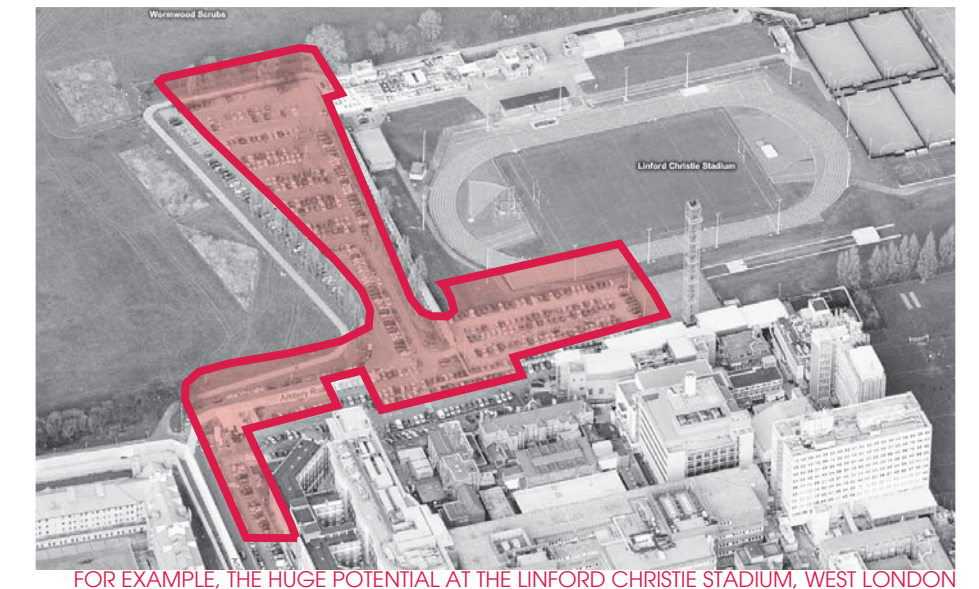
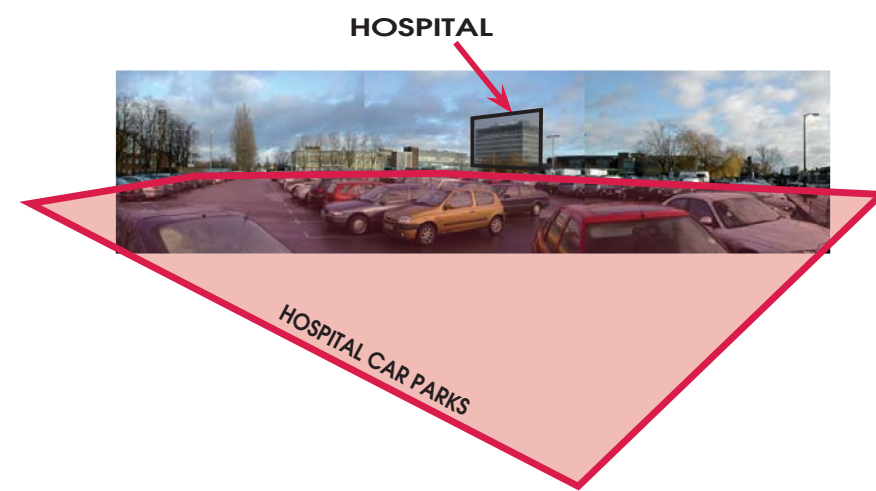
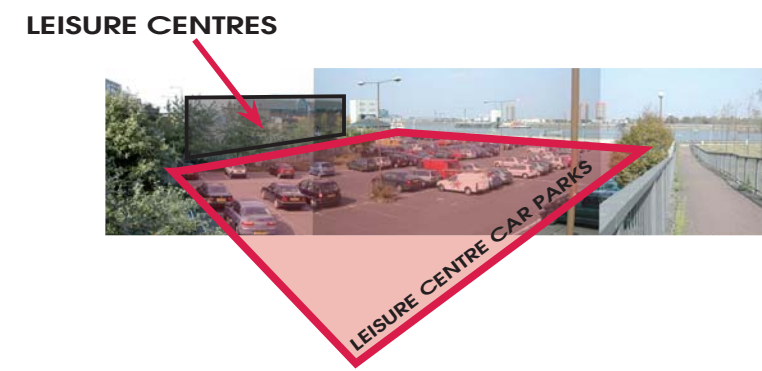

SOLUTION

Dynamic Spaces...

A linked strategy across London to unlock vast swathes of under utilised local authority car parking and make better use of public land portfolios, provide pioneering Housing Associations with new sites for vibrant mixed tenure schemes and boost funds to create exemplary public facilities, such as new leisure centres, health centres, schools, nurseries & hospital facilities. **This will transform rundown urban eyesores into well used mixed-use developments, providing balanced communities and exemplary inclusive public facilities for all.**

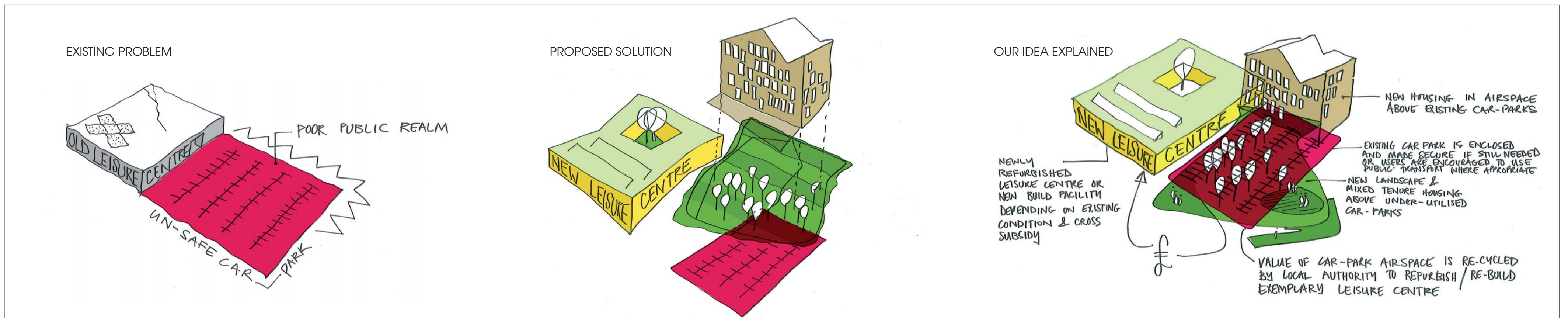

RESULT

This idea will create the capacity for at least:

- 30,000** New mixed tenure homes
- 30** New leisure centres
- 30** New hospital or medical facilities
- 100's** of new social and community centres

OPPORTUNITIES ACROSS LONDON'S BOROUGHES:

- NEW LEISURE CENTRE OPPORTUNITIES
- NEW MEDICAL FACILITY OPPORTUNITIES

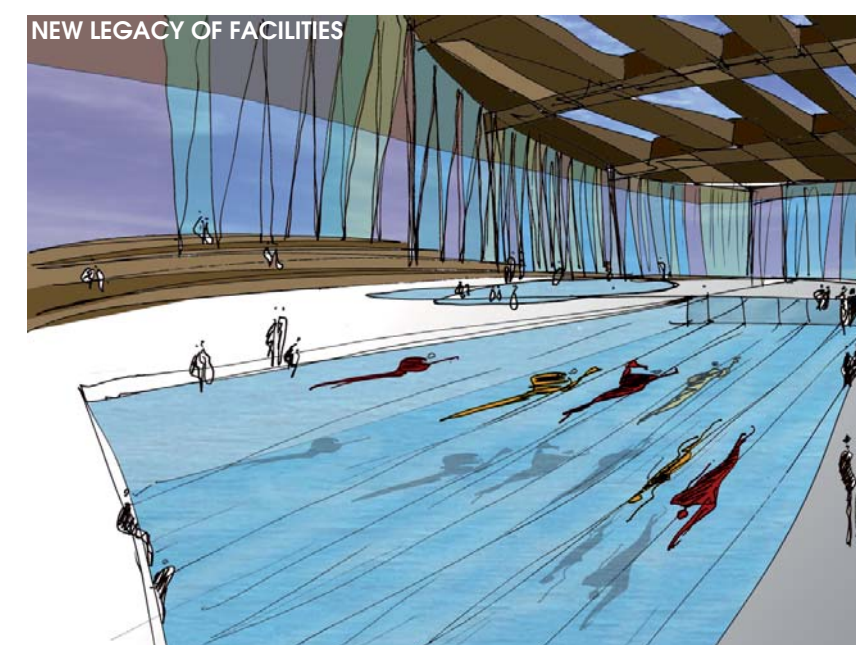
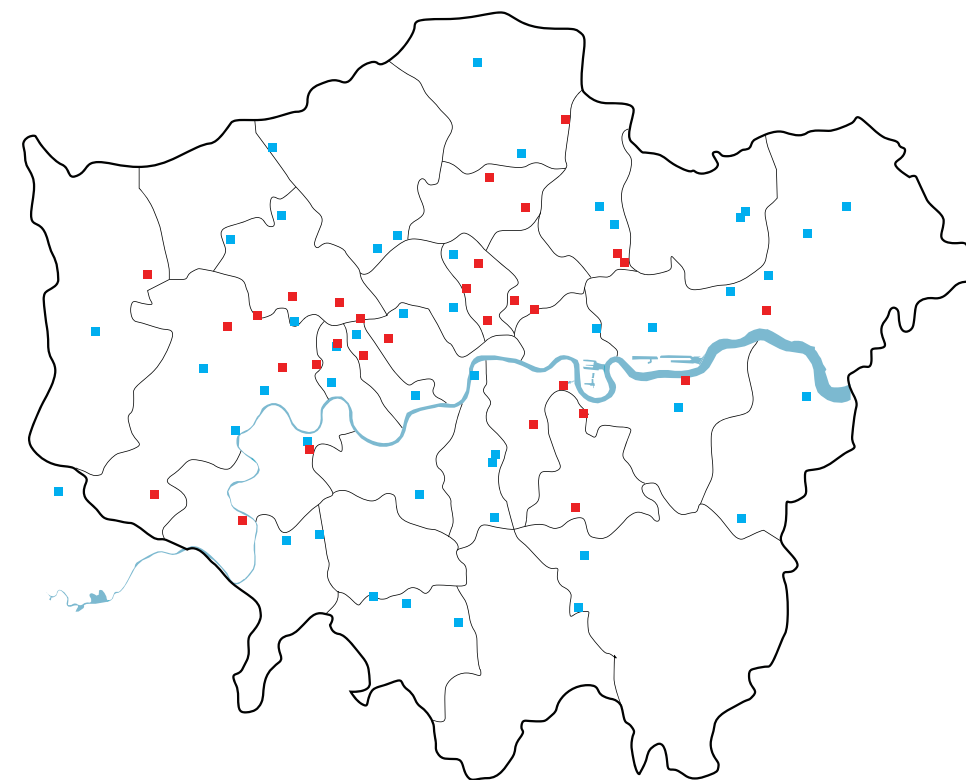

Providing a new generation of 21st century leisure centres, hospitals and stations for London, with new facilities and affordable housing funded through cross-subsidy from the value of land and airspace.